



# WAPA

WISCONSIN ASPHALT PAVEMENT ASSOCIATION

57TH ANNUAL

# CONFERENCE & BUSINESS MEETING

NOVEMBER 29-30, 2016

MARRIOTT WEST | MADISON, WISCONSIN

## Conference Program

*Thank you to our Conference Partners:*



**BP Asphalt USA**



**FLINT HILLS**  
— RESOURCES® —

Tuesday, November 29

WAPA Members Only

- 8:00 – 9:00 WAPA Board of Directors Annual Business Meeting (Milwaukee Room)
- 9:00 – 10:00 WAPA Executive Committee Meeting (Milwaukee Room)

Registration from 9 a.m. to 5 p.m.

General Sessions

- 10:00 – 10:15 Welcome, Brandon Strand, WAPA Executive Director  
Brian Endres, WAPA President, Payne & Dolan
- 10:15 – 10:30 Opening Comments, Kevin Kelly, NAPA Chairman, Walsh & Kelly
- 10:30 – 11:00 Wisconsin DOT Update, Dewayne Johnson, Deputy Administrator  
for the Regions
- 11:00 – 11:30 Asphalt Specification Update, Barry Paye, WisDOT Chief Materials Engineer
- 11:30 – Noon Transportation Funding and Legislative Update, Eric Petersen,  
Wimmer & Company
- Noon – 1:00 Awards and Scholarship Luncheon

Concurrent Breakout Sessions

	Salon B & C	Salon G & H	Salon A	Salon F
Session 1: 1:15 - 2:15	Longitudinal Joint Construction	Enhanced Durability and Increased Density	Innovative Paving Programs at the Local Level	Asphalt Binder Modification
Session 2: 2:30 - 3:30	Longitudinal Joint Construction	Enhanced Durability and Increased Density	Plant Operations	Ethics Training
Session 3: 3:45- 4:45	Innovative Paving Programs at the Local Level	Asphalt Binder Modification	Plant Operations	Ethics Training

- 5:00 – 6:00 Cocktail Reception
- 6:00 – 7:00 Dinner
- 7:30 – close Hospitality Suite

# CONFERENCE AGENDA

# DAY 2

## Wednesday, November 30

*Registration from 8 a.m. to 10 a.m.*

### General Sessions

- 8:30 – 9:15      Asphalt Market Overview and Expectations, Nasreen Tasker, Argus Media Inc.
- 9:15 – 9:45      Asphalt Pavement Alliance Update, Dan Staebell, APA Northcentral  
Regional Director
- 10:15 – 10:45      Wisconsin Towns Association Update, Mike Koles, WTA Executive Director
- 10:45 – 11:30      Federal Highway Administration Update, Michael Davies, FHWA  
Division Administrator



## AMERICAN HIGHWAY PRODUCTS LTD. MANHOLE RISER SPECIALISTS

DAN PETERSON  
SALES REPRESENTATIVE  
CELL: 847-738-1604  
FAX: 847-201-1495  
ROUND LAKE, IL 60073  
EMAIL: GETUMINC@COMCAST.NET

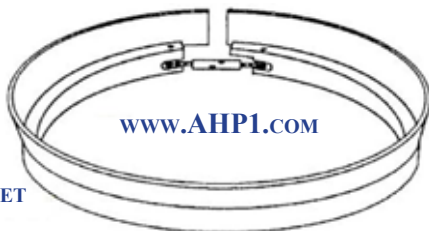

AMERICAN HIGHWAY PRODUCTS  
TOLL:FREE: 888-272-2397  
FAX: 330-874-3800

1723 STRASBURG BOLIVAR RD. N.W.  
BOLIVAR, OHIO 44612

# CONVENTION MAP



- Registration \_\_\_\_\_ Pre-Convene Area
- General Sessions \_\_\_\_\_ Ballrooms D & E
- Exhibits and Breaks \_\_\_\_\_ Atrium
- Technical Breakout Sessions \_\_\_\_\_ See Page 2
- Lunch \_\_\_\_\_ Michigan Room
- Reception \_\_\_\_\_ Wisconsin Room
- Dinner \_\_\_\_\_ Michigan Room
- Hospitality Suite \_\_\_\_\_ Room #226



A U T O M A T I O N ◀ INC



MASTERS OF COMPACTION

# GENERAL SESSION SPEAKER BIOGRAPHIES

## *Kevin Kelly*

Kevin Kelly is President and CEO of Walsh & Kelly, Inc., a highway construction company with offices in Griffith and South Bend, Indiana. Walsh & Kelly operates five hot mix plants in South Bend, Griffith, Valparaiso, LaPorte and Lowell Indiana. He is the Chairman of the National Asphalt Pavement Association. He serves on the Build Indiana Council, where he is immediate Past Chairman, the Conexus Indiana Logistics Council, and the Indiana Toll Road Oversight Board. The Indiana Construction Association named him Indiana Contractor of the Year in 2006 and 2007. He is a 1977 graduate of the University of Notre Dame and received an EMBA from Notre Dame in 1987.

## *Dewayne Johnson*

Dewayne Johnson is the Deputy Administrator-Regions. He served two years as Director of the Bureau of Traffic Operations, and prior to that, Dewayne was Director of Southeast Region for nine years. He joined WisDOT in 1989 as an engineer in the Waukesha office, where he advanced to Design Supervisor in 1993, Project Development Supervisor in 1995, Central Group Project Development Chief in 2000 and Southeast Region District Deputy

Director in 2001. Dewayne is a graduate of the University of Wisconsin, with a degree in Civil and Environmental Engineering. He is a registered Professional Engineer in Wisconsin.

## *Barry Paye*

Barry Paye currently serves as the Department's Chief Materials Engineer in the Bureau of Technical Services, and has worked with Wisconsin DOT since 2006. He serves as the WisDOT representative on several regional and national committees. Previously, he served as the WisDOT Central Office Material's Lab Supervisor, and in several construction and materials roles in the Northeast Region. Prior to working for WisDOT, Barry worked for the Minnesota DOT for over 4 years, working on their first major design build project. Barry has his BS and MS in Civil Engineering from UW-Madison, specializing in construction management and HMA research. He is a licensed Professional Engineer in Minnesota and Wisconsin.

## *Eric Petersen*

For the past 18 years, Mr. Petersen has been known as one of the most effective government relations consultants in Wisconsin. An attorney, Mr. Petersen has

# GENERAL SESSION SPEAKER BIOGRAPHIES

served as President of Wimmer & Company since 1998, and previous to that Vice President for four years. Prior to joining Wimmer & Company, Mr. Petersen was a Public Finance Analyst and Associate for Bear Stearns in their New York Office. Mr. Petersen is a graduate of the University of Pennsylvania with a BA in History, BA in Foreign Policy (1990); and the University of Wisconsin Law School (1997). In addition to his role with Wimmer & Company, Mr. Petersen serves on the Board of the following organization: American Players Theater, Wisconsin Veterans Museum, Madison Club and the University of Wisconsin Alumni Association.

## *Nasreen Tasker*

Nasreen Tasker has 24 years of experience with the US, Americas and global asphalt markets. She is an expert in asphalt fundamentals, trend analysis, refining economics and pricing. Nasreen developed Argus Asphalt Report eighteen years ago, which was the first international report on asphalt pricing in the world. She started all four global asphalt conferences at Argus and has chaired thirty asphalt events. Before Argus, Nasreen worked in the asphalt group at Poten & Partners. Prior to Poten, she was business development & planning analysis at Phibro Energy. Her oil industry career started

in the management-training program at Conoco (now ConocoPhillips) in the supply and distribution department. Nasreen has an MBA and two Bachelor of Science degrees.

## *Dan Staebell*

Dan Staebell has been in the asphalt paving industry for over 35 years, having roles with paving contractors, asphalt cement suppliers, and with Iowa's Asphalt Pavement Association. Dan joined the Asphalt Pavement Alliance in March 2016, with his area of focus being the North Central portion of the United States. The APA partners consist of the National Asphalt Pavement Association, Asphalt Institute, and the 39 State Asphalt Pavement Associations.

## *Mike Koles*

Mike Koles is the Executive Director of the Wisconsin Towns Association, a collaboration of 1,250 towns and 18 villages representing over 10,000 local officials, which specializes in providing education, lobbying, and legal information services to its members. He has been involved in administrative and educational aspects of local government for over 20 years, including 16 years as a UW-Extension Community Development Educator. He is the Vice President of the Iola-Scandinavia School Board; Treasurer for

# GENERAL SESSION SPEAKER BIOGRAPHIES

Iola Living Assistance and the local chapter of the National Wild Turkey Federation. Mike has a Bachelor’s Degree in Political Science from Wartburg College (Waverly, Iowa) and a Master’s Degree in Urban and Regional Planning from UW-Madison.

## Michael Davies

Mike Davies is the Wisconsin Division Administrator for the Federal Highway Administration. He is responsible for administering the stewardship and oversight of the Federal-aid highway program in the State of Wisconsin. Prior to his appointment as Division Administrator, Mr. Davies served as the FHWA’s Director of Project Delivery and Engineering Services for FHWA’s Central Federal Lands Highway Division. Mr. Davies has also served as the Assistant Division Administrator in New York where he advanced Every Day Counts initiatives. He has over 30-years of transportation experience. He has a Bachelor of Science degree in Civil Engineering from the University of Alaska and a Master of Science degree in Civil Engineering from the University of Maine. He is a registered professional engineer.





**Ken Mayo**

C: 423.322.8343kmayo@astecinc.com







*The Asphalt Authority*

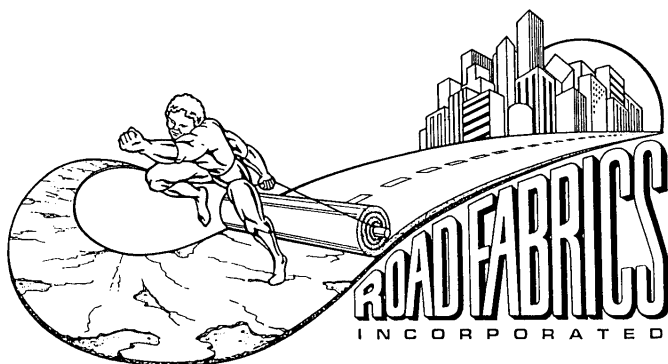

# TECHNICAL BREAKOUT SESSION SUMMARIES

## ***Longitudinal Joint Construction (1 PDH)***

Mark Blow P.E., Asphalt Institute

Signe Reichelt P.E., Behnke Materials Engineering

This session will highlight the importance of a properly constructed longitudinal joint, construction best practices, and the local implementation activity to improve the performance of the longitudinal joints in Wisconsin. You will not only get the national perspective, but the specific density data details and paving techniques from the recently completed Wisconsin Highway Research Program study.

## ***Enhanced Durability and Increased Density (1 PDH)***

Dave Johnson P.E., Asphalt Institute

Steve Hefel P.E., Wisconsin DOT

In this session you will hear about the 2016 Enhanced Durability and Increased Density FHWA demonstration projects constructed throughout the country, and Wisconsin's own STH 21 project details. You will learn about the importance of in-place density and its effect on pavement durability, longevity, and increased performance.

## ***Innovative Paving Programs at the Local Level (1 PDH)***

Ghassan Korban, City of Milwaukee

Todd Hughes, Payne & Dolan

Howard B. Crofoot P.E., City of Platteville

Jerid Baranczyk, Iverson Construction

This session highlights innovative paving programs the City of Milwaukee and the City of Platteville have utilized to extend pavement life, improve ride quality, remove distresses and increase pavement structure, providing both the owner and producer perspectives.

## ***Asphalt Binder Modification (1 PDH)***

Dr. Geoffrey M. Rowe P.E., Abatech Inc.

In this session you will hear about different modification types, processes, benefits, concerns, applications, and more that are currently being utilized across the country; and when engineers should incorporate this technology into their projects.

# TECHNICAL BREAKOUT SESSION SUMMARIES

## *Practices of Peak Performing Plants (1 PDH)*

Steve Elam, Stansteel/Hotmix Parts

This session will discuss how to use many of the tried and proven “old school” methods of plant operations while incorporating new technologies and methods to increase plant efficiency and productivity. Discussions will include how plants are coping with the increasing varieties of mix designs and increased recycled materials, while producing high quality mixes, operating safely, and maintaining profitability.

## *Ethics Training (1 PDH)*

Jeff Russell, UW-Madison

Back by popular demand, this session will focus on the fundamental canons of professional conduct and other appropriate administrative rules or regulations. The discussion is designed to demonstrate a working knowledge of professional ethics and satisfy the requirement for “professional conduct and ethics”.



## Need Equipment? Choose Roland

*Reliable Equipment • Responsive Service  
24-Hour On-site Emergency Service Available*

### Call The Location Nearest You!

De Forest 608-842-4151	Eau Claire 715-874-5400	Schofield 715-355-9898
De Pere 920-532-0165	Franksville 262-835-2710	

**KOMATSU**  
**HAMM**  
**VÖGELE**  
**RSCCO**  
**LeBoey**  
**Wirtgen**  
**GRADALL**

15 locations throughout WI, IL, IN, MI, and MO

## NEW PRODUCTS. SAME COMMITMENT.

For over 50 years, American State has provided our customers with a wide range of equipment solutions – from paving and construction to earth moving, material handling and cranes. We are now proud to announce three new additions to our line-up: **Roadtec**, **Sakai** and **Mauldin**. These new additions represent American State's continued commitment to meeting all your equipment needs.





**ASE**  
AMERICAN STATE EQUIPMENT  
*The Equipment People*  
[www.amstate.com](http://www.amstate.com)

©2015 American State Equipment

# 2016 ENVIRONMENTAL LEADERSHIP AWARDS

## *Renewal Awards—Permanent Plants*

Northeast Asphalt Control 67 (Glenmore)

Payne & Dolan Control 5 (Fitchburg)

## *Renewal Awards—Portable Plants*

Northwoods Paving Plant 67 (Cable)

Northeast Asphalt Control 26 (Kiel)

## *New Award—Portable Plants*

Mathy Construction Company Plant 92 (Black River Falls)

**Congratulations to all recipients!**



**Zydex®**  
Sustainability Through Innovation



# PERFORMANCE You Can Count On



[www.miller-bradford.com](http://www.miller-bradford.com)

Operating since 1944, Miller-Bradford & Risberg is a family business dedicated to excellence for all your equipment needs.

## Wisconsin

Sussex 800-242-3115  
DeForest 800-585-7219  
Eau Claire 800-585-7232

De Pere 800-638-7448  
Marathon 888-886-4410

## Michigan

Negaunee 800-562-9770

## Illinois

Rockford 800-585-7231



# SUPER-SLIDE

Time for a Liner . . .

*Super-Slide UHMW & HMW Plastics promote flow and release of materials.*

Horn Plastic Inc.  
825 Business Park Road  
Wisconsin Dells WI 53965  
[www.superslide.com](http://www.superslide.com)

800-373-7448

sales@superslide.com



# EXHIBITS

The Exhibit Area is open from 8:00 a.m. to 5:00 p.m. on Tuesday and from 7:30 a.m. to 11:30 a.m. on Wednesday. Events taking place near the Exhibit Area are:

## Tuesday, November 29

8:00 a.m. – 11:45 a.m. \_\_\_\_\_ Coffee Station  
1:15 p.m. – 5:00 p.m. \_\_\_\_\_ Refreshment and Coffee Station

## Wednesday, November 30

7:30 a.m. – 11:30 a.m. \_\_\_\_\_ Breakfast and Coffee Station

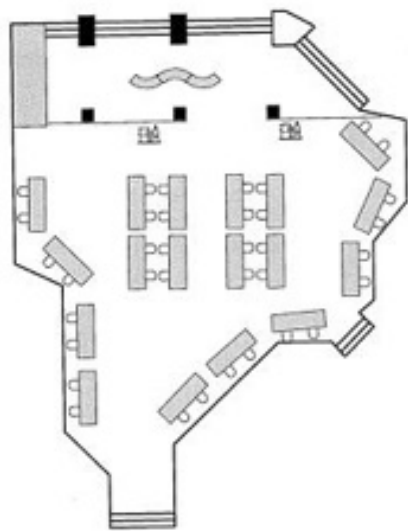

### HOW DID WE DO?

Soon after the conference, WAPA will send out a short online survey to all attendees.

Please take a moment to share your thoughts.

What did you find valuable at the conference? What aspects could be improved?

Your input will help us make the WAPA conference even better next time.

*Thanks!*

# THANK YOU TO OUR SPONSORS

## *Conference Partners*

BP Asphalt  
Flint Hills Resources

## *Gold Level Sponsors*

American State Equipment  
Aring Equipment Company  
Roland Machinery Inc.

## *Silver Level Sponsors*

Astec Industries Inc.  
CWMF Corporation  
Fabick Cat Equipment Company

## *Bronze Level Sponsors*

AkzoNobel Surface Chemistry  
Antigo Construction  
Henry G. Meigs

## *Reception*

American State Equipment  
Aring Equipment Company

## *Dinner*

Sakai America

## *Hospitality Suite*

Miller-Bradford & Risberg

## *Coffee Break*

WEM Automation

## *Breakfast*

Roadtec Inc.

## *Exhibiting Sponsors*

American Highway Products  
American State Equipment  
Astec Industries  
Breakthrough Technologies  
CWMF Corporation  
Fabick Cat Equipment Company  
Horn Plastics Inc.  
Pine Instrument Company  
Road Fabrics Inc.  
Road Science, Division of ArrMaz  
Roadtec Inc.  
Roland Machinery Inc.  
Testquip LLC  
WEM Automation  
Zydex Inc.

## SPONSORED MEDIA PARTNER



[argusmedia.com](http://argusmedia.com)

# WAPA MEMBERS

## **WAPA Producer Members**

American Asphalt of Wisconsin  
Gasser, D.L., Construction Company  
Iverson Construction  
Mathy Construction Co.  
Monarch Paving Company  
Murphy Construction Co.  
Northeast Asphalt, Inc.  
Northwoods Paving  
Payne & Dolan, Inc.  
Pitlik & Wick, Inc.  
Rock Road Companies, Inc.  
Senn Blacktop, Inc.  
Sherwin Industries, Inc.  
Stark Pavement Corp  
Tri-County Paving, Inc.  
Wolf Paving

## **WAPA Liquid Asphalt Supplier Members**

BP Asphalt  
Calumet Specialty Products Partners, L.P.  
Flint Hills Resources  
Meigs, Henry G., LLC

## **WAPA Associate Members**

Adams Asphalt Plant Services Inc.  
Akzo Nobel Surface Chemistry  
American State Equipment Co., Inc.  
Antigo Construction, Inc.  
Aon Risk Services  
Aring Equipment Company  
Asphalt Reheat Systems  
Asphalt Technologies Group  
Astec Industries, Inc.  
Baxter & Woodman, Inc.  
Becher-Hoppe Associates Inc.  
Behnke Materials Engineering  
Benchmark, Inc.  
Bloom Companies, LLC  
Carbolite, Inc.

Century Fence Company  
CGC, Inc.  
Chicago Testing Laboratory Inc.  
Cicchini Asphalt, LLC  
CWMF Corporation  
Dillman  
Elsey Construction Products  
Engineered Additives  
Fabick Cat Equipment Company  
Fahrner Asphalt Sealers, LLC  
FORTA Corporation  
GKW, LLC  
GRAEF  
Heatec, Inc  
Horn Plastics Inc.  
Inspec, Inc  
James Peterson Sons, Inc.  
Kwik Trip  
Lafarge North America Inc.  
Meigs Trucking, Inc.  
Milestone Materials  
Miller-Bradford & Risberg  
Motion Engineering, Inc.  
MSA Professional Services, Inc  
Northwind RAS, LLC  
OMNNI Associates, Inc.  
Pavement Consulting LLC (PCI)  
Pavement Technology, Inc.  
Positioning Solutions Company  
Professional Testing Service  
RC Pavers  
Roadtec Inc.  
Roland Machinery Inc.  
Ruekert & Mielke  
Specialty Engineering Group (SEG)  
Stansteel  
Troxler Electronic Laboratories Inc.  
W.K. Construction, Inc  
WEM Automation  
Yahara Materials, Inc.

## **Contact WAPA**

Remember, when looking for services or supplies, please consider a WAPA member. If you know a company who should be a member, please be sure to contact us.

Wisconsin Asphalt Pavement Association  
4600 American Parkway, Suite 201  
Madison, Wisconsin 53718  
(608) 255-3114

We greatly appreciate your membership and support of the Wisconsin Asphalt Pavement Association.